



# Weather Resistant Lift Handle

DC4020

- Outdoor lift handle resists moisture, dust, salt and extreme temperatures
- Unique handle styling aids in opening an application
- Available keyed-alike or keyed-different
- 200 Key Changes
- Automotive style reversible key with optional plastic over molding
- Plug removable
- Automotive style dust shutter

## Material and Finish

- Housing: Zinc alloy with stainless steel scalp and upgraded dust shutter
- Finish: Textured black powder coat

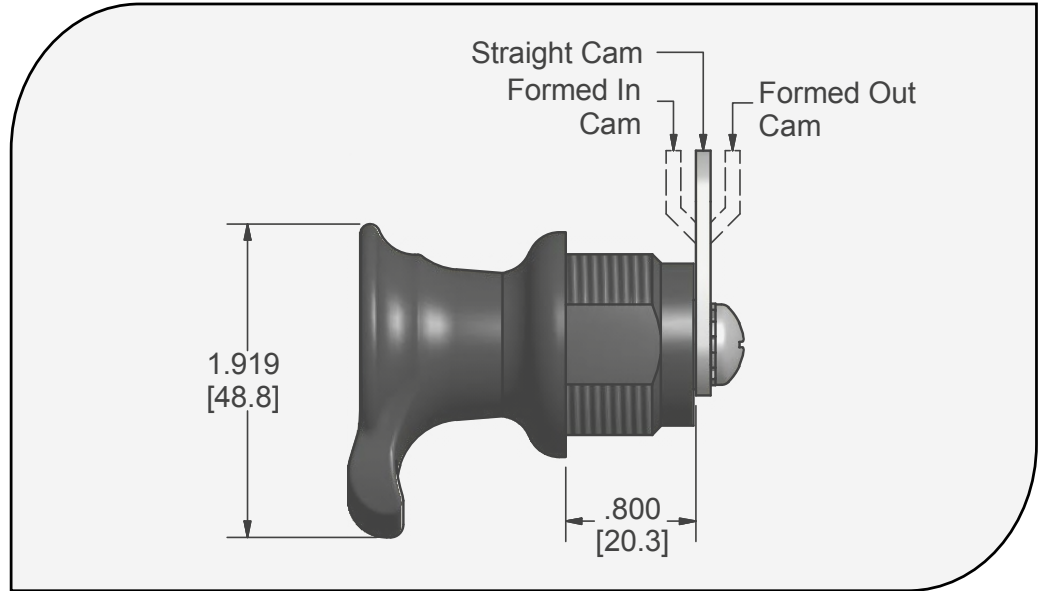

| Part Number | Housing Length [B-Dim]* |             |
|-------------|-------------------------|-------------|
|             | Inches                  | Millimeters |
| DC4020      | 0.800                   | 20.3        |

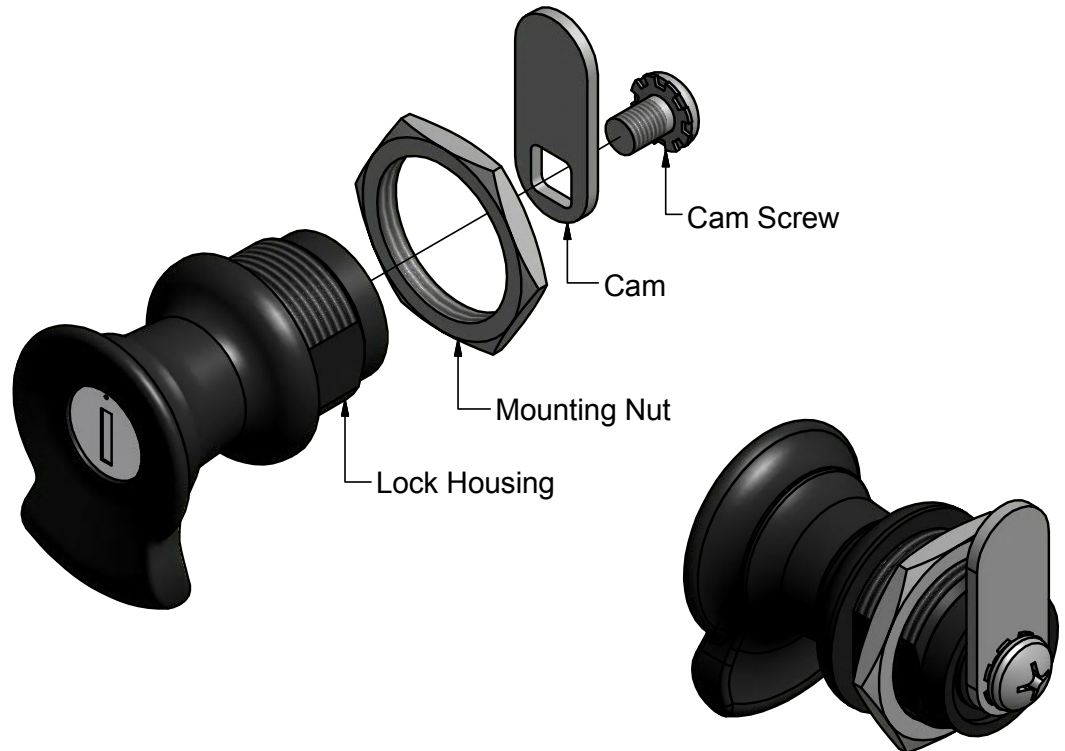

**Illinois Lock Company**  
A division of the Eastern Company

www.illinoislock.com • sales@illinoislock.com • 847-537-1800



# Weather Resistant Lift Handle

DC4020

## Cam Rotation and Installation

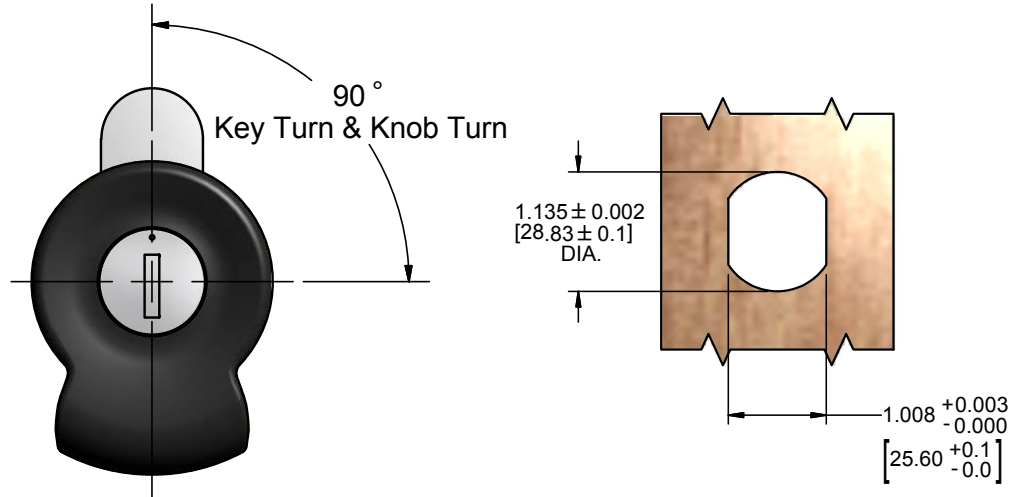

## Cam Types

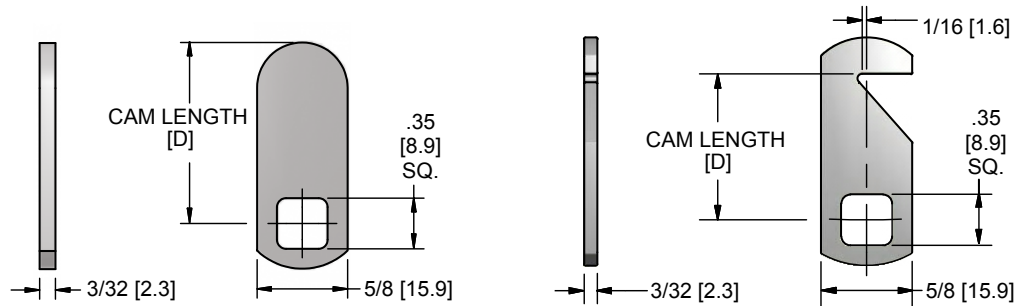

| Straight Cams |                     |             |
|---------------|---------------------|-------------|
| Part Number   | Cam Length [D-Dim]* |             |
|               | Inches              | Millimeters |
| TS2201-05     | 5/8                 | 15.9        |
| TS2201-07     | 11/16               | 17.5        |
| TS2201-09     | 3/4                 | 19.1        |
| TS2201-13     | 7/8                 | 22.2        |
| TS2201-17     | 1                   | 25.4        |
| TS2201-19     | 1-1/8               | 28.6        |
| TS2201-21     | 1-1/4               | 31.7        |
| TS2201-23     | 1-3/8               | 34.9        |
| TS2201-25     | 1-1/2               | 38.1        |
| TS2201-27     | 1-5/8               | 41.3        |
| TS2201-29     | 1-3/4               | 44.4        |
| TS2201-31     | 1-7/8               | 47.6        |
| TS2201-33     | 2                   | 50.8        |

| Hook Cams   |                     |             |
|-------------|---------------------|-------------|
| Part Number | Cam Length [D-Dim]* |             |
|             | Inches              | Millimeters |
| TS2204-05   | 5/8                 | 15.9        |
| TS2204-07   | 11/16               | 17.5        |
| TS2204-09   | 3/4                 | 19.1        |
| TS2204-13   | 7/8                 | 22.2        |
| TS2204-17   | 1                   | 25.4        |
| TS2204-19   | 1-1/8               | 28.6        |
| TS2204-21   | 1-1/4               | 31.7        |
| TS2204-23   | 1-3/8               | 34.9        |
| TS2204-25   | 1-1/2               | 38.1        |
| TS2204-27   | 1-5/8               | 41.3        |
| TS2204-29   | 1-3/4               | 44.4        |
| TS2204-31   | 1-7/8               | 47.6        |
| TS2204-33   | 2                   | 50.8        |

\* length tolerance +/- .039" [1mm]

**Illinois Lock Company**  
A division of the Eastern Company

www.illinoislock.com • sales@illinoislock.com • 847-537-1800



# Weather Resistant Lift Handle

DC4020

## Cam Types - Continued

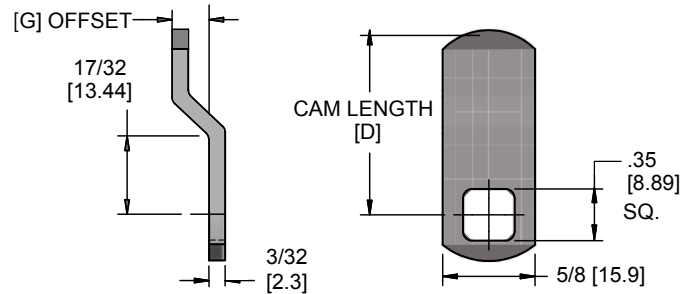

| Part Number  | Offset Cams         |             |                        |             |
|--------------|---------------------|-------------|------------------------|-------------|
|              | Cam Length [D-Dim]* |             | Offset Length [G-Dim]* |             |
|              | Inches              | Millimeters | Inches                 | Millimeters |
| TF2201-13-02 | 7/8                 | 22.2        | 1/16                   | 1.6         |
| TF2201-13-04 | 7/8                 | 22.2        | 1/8                    | 3.2         |
| TF2201-13-06 | 7/8                 | 22.2        | 3/16                   | 4.8         |
| TF2201-15-08 | 15/16               | 23.8        | 1/4                    | 6.4         |
| TF2201-17-02 | 1                   | 25.4        | 1/16                   | 1.6         |
| TF2201-17-04 | 1                   | 25.4        | 1/8                    | 3.2         |
| TF2201-17-06 | 1                   | 25.4        | 3/16                   | 4.8         |
| TF2201-19-08 | 1-1/8               | 28.6        | 1/4                    | 6.4         |
| TF2201-21-02 | 1-1/4               | 31.7        | 1/16                   | 1.6         |
| TF2201-21-04 | 1-1/4               | 31.7        | 1/8                    | 3.2         |
| TF2201-21-06 | 1-1/4               | 31.7        | 3/16                   | 4.8         |
| TF2201-21-08 | 1-1/4               | 31.7        | 1/4                    | 6.4         |
| TF2201-25-02 | 1-1/2               | 38.1        | 1/16                   | 1.6         |
| TF2201-25-04 | 1-1/2               | 38.1        | 1/8                    | 3.2         |
| TF2201-25-06 | 1-1/2               | 38.1        | 3/16                   | 4.8         |
| TF2201-25-08 | 1-1/2               | 38.1        | 1/4                    | 6.4         |
| TF2201-29-02 | 1-3/4               | 44.4        | 1/16                   | 1.6         |
| TF2201-29-04 | 1-3/4               | 44.4        | 1/8                    | 3.2         |
| TF2201-29-06 | 1-3/4               | 44.4        | 3/16                   | 4.8         |
| TF2201-29-08 | 1-3/4               | 44.4        | 1/4                    | 6.4         |
| TF2201-33-02 | 2                   | 50.8        | 1/16                   | 1.6         |
| TF2201-33-04 | 2                   | 50.8        | 1/8                    | 3.2         |
| TF2201-33-06 | 2                   | 50.8        | 3/16                   | 4.8         |
| TF2201-33-08 | 2                   | 50.8        | 1/4                    | 6.4         |



# Weather Resistant Lift Handle

DC4020

## Accessories/Replacement Parts



**Cam Screw 1/4-28**  
PN: S23032G



**Barrel Nut 1-1/8**  
PN: S9194



**Head Gasket**  
PN: P9261