

CONFIDENTIAL NOTICE: This drawing and the designs, specifications and engineering information disclosed hereon are the property of Eberhard Manufacturing Company and are not to be disseminated or reproduced without express written consent. The drawing is loaned in confidence and then only for consideration of the matter disclosed hereon. In accepting loan of this drawing, recipient agrees to keep it and the matter disclosed hereon in confidence and not to use nor permit their use in any way detrimental to Eberhard Manufacturing Company, Division of the Eastern Company, 21944 Drake Road, Cleveland, Ohio 44148-9712 © 2015 EBERHARD MFG. CO.

REVISION HISTORY					
REV	DESCRIPTION	EN	DATE	REV. BY	APVD. BY
	RELEASE WAS M11747-RL	5732	12/11/2015	GJB	MR

WARNING
THIS PRODUCT MUST NOT BE USED FOR PERSONAL RESTRAINT APPLICATIONS

MINI ROTARY IS A TRADEMARK OF EBERHARD MFG. CO., DIVISION OF THE EASTERN COMPANY.

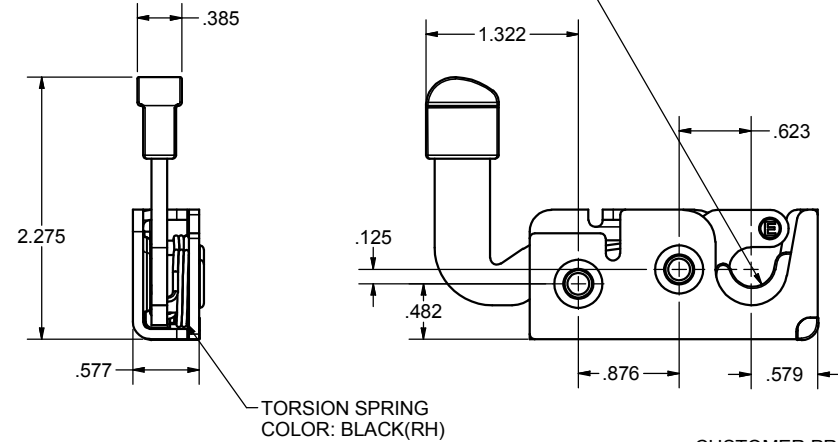
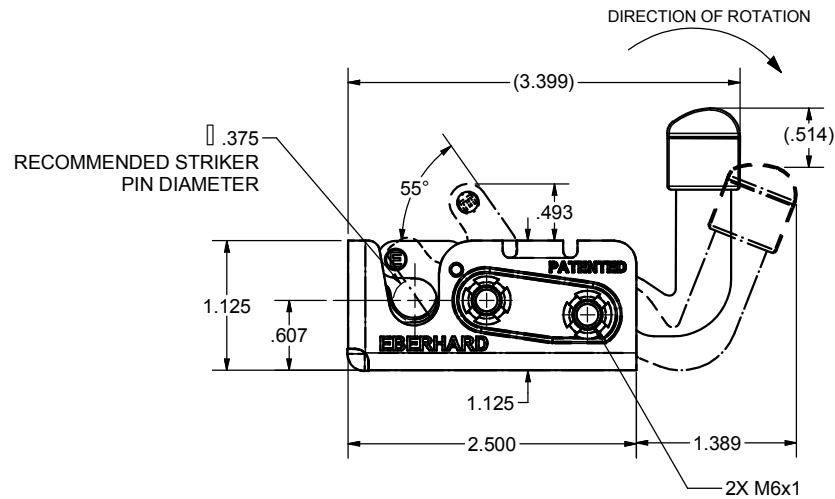
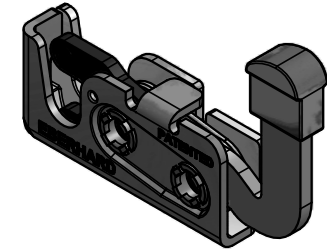
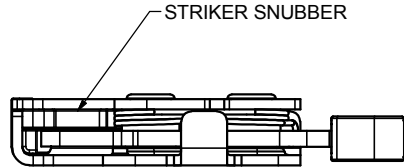

- NOTES:
- USE M6X1 CLASS 8.8 BOLTS FOR INSTALLATION.
MAXIMUM RECOMMENDED INSTALLATION TORQUE: 14 FT-LB.
 - MAX LOAD RATING - 750 LBS
 - REFERENCE P.N. - 95-248-BX54-MBR-64 OR 95-248-BX54-MBL-64 FOR 54 PIECES IN A BOX
 - EBERHARD AVAILABLE FINISHES: -
 - (64) ZINC WITH YELLOW CONVERTER WITH EVERLUBE INTERNAL COMPONENTS
 - (BG) BEARING GREASE

CUSTOMER PRINT
SHEET 1 OF 2
RIGHT HAND SHOWN
LEFT HAND OPPOSITE

EBERHARD MANUFACTURING CO.
DIVISION OF
THE EASTERN COMPANY
CLEVELAND, OHIO 44149-9712

UNLESS OTHERWISE SPECIFIED TOLERANCES ARE AS FOLLOWS:	DATE	12/11/2015	NAME	SINGLE STAGE MINI-ROTARY LOCK ASSEMBLY W/ M6x1 MOUNTING THREADS, HEAVY SPRING, AND STRIKER SNUBBER	
	DR. BY	GJB		MATERIAL	PART NUMBER
ANGLES:	∠ 20	SCALE	1:1		
2 PLACE DEC:	∠ .03	CHK. BY	MR		
3 PLACE DEC:	∠ .015				
ALL HOLES:	∠ .005				

C:\Working_Folder\Archive\Pro2\248\95-248-MB RL SH1.dwg