

CONFIDENTIAL NOTICE: This drawing and the designs, specifications and engineering information disclosed hereon are the property of Eberhard Manufacturing Company and are not to be disseminated or reproduced without express written consent. The drawing is loaned in confidence and then only for consideration of the matter disclosed hereon. In accepting loan of this drawing, recipient agrees to keep it and the matter disclosed hereon in confidence and not to use nor permit their use in any way detrimental to Eberhard Manufacturing Company, Division of the Eastern Company, 21944 Drake Road, Cleveland, Ohio 44149-9712. © 2010 EBERHARD MFG. CO.

REVISION HISTORY			
REV	DESCRIPTION	EN	DATE
	REVISED AND REDRAWN	EN 5487	8-20-10
1	REMOVED DIMPLE FROM FRONT FACE	EN 5484	12-31-10

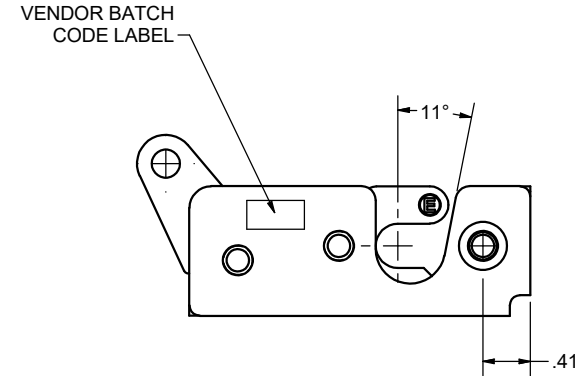
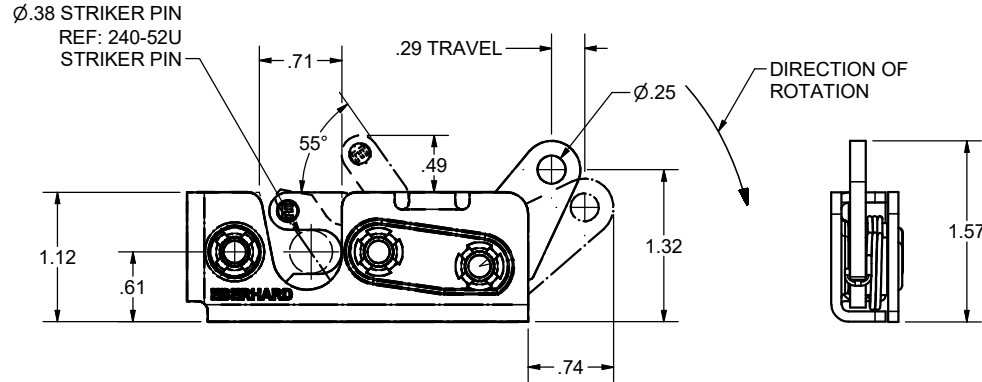
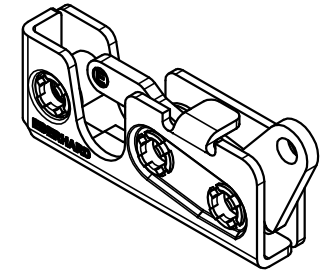
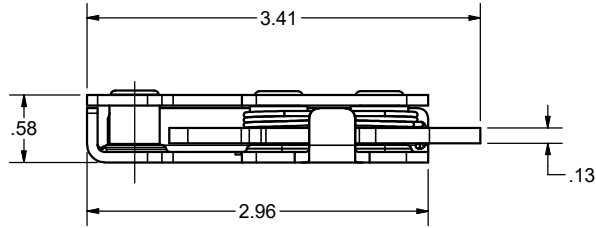

- NOTES:
- FINISH:  
CASES - ZINC, FC (24)  
INTERNAL COMPONENTS - EVERLUBE, FC (54)
  - USE 1/4-20 GRADE 8 BOLTS FOR INSTALLATION  
RECOMMENDED TORQUE FOR TIGHTENING: 14 FT-LBS.
  - MAX. LOAD RATING: 750 LBS.

RIGHT HAND SHOWN  
LEFT HAND OPPOSITE  
CUSTOMER PRINT  
SHEET 1 OF 2



SUPERSEDES DRAWING 8-247-R/L SHEET 1 OF 2 DATED 6-18-10

UNLESS OTHERWISE SPECIFIED TOLERANCES ARE AS FOLLOWS:		DATE 8/12/2010	NAME SINGLE STAGE MINI-ROTARY LOCK	
ANGLES:	± 2'	DR BY FLP	MATERIAL	
2 PLACE DEC:	± .03	SCALE FULL		
3 PLACE DEC:	± .015	CHK BY		
ALL HOLES:	± .005		PART NUMBER 8-247-BR/L	

EBERHARD MANUFACTURING CO.  
DIVISION OF  
THE EASTERN COMPANY  
CLEVELAND, OHIO 44149-9712