

6-1969-1a1

CONFIDENTIAL NOTICE: This drawing and the designs, specifications and engineering information disclosed hereon are the property of Eberhard Manufacturing Company and are not to be disseminated or reproduced without express written consent. The drawing is loaned in confidence and then only for consideration of the matter disclosed hereon. In accepting loan of this drawing, recipient agrees to keep it and the matter disclosed hereon in confidence and not to use nor permit their use in any way detrimental to Eberhard Manufacturing Company, Division of the Eastern Company, 21944 Drake Road, Cleveland, Ohio 44149-9712 © 2008 EBERHARD MFG. CO.

NO	CHANGE	ENGL. NO.	DATE
	RELEASED	EN 5354	5-30-08
1	ADDED FINISH (30)	EN 5602	5-1-2013

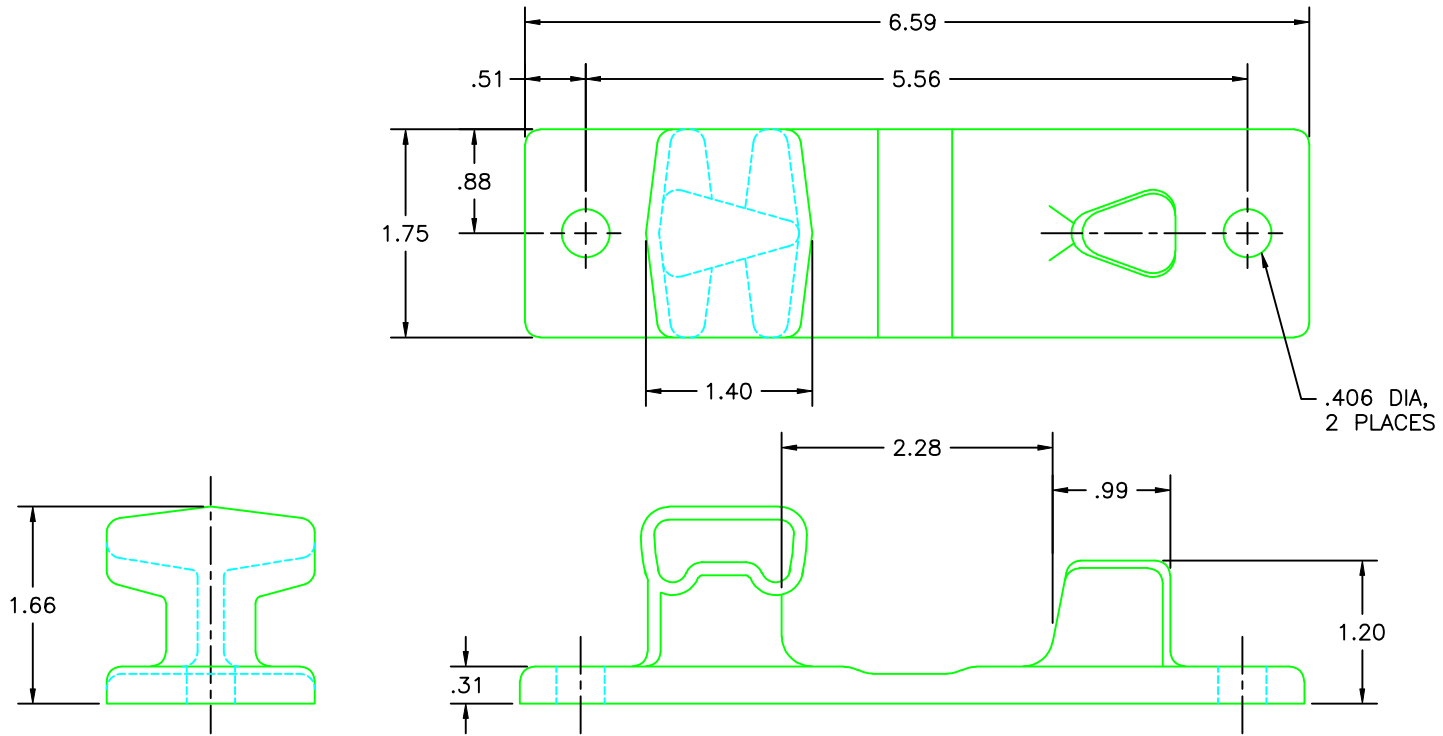

CUSTOMER PRINT
SHEET 1 OF 2

NOTE: FINISH - HOT DIP GALVANIZED, FC (13) (30) BLACK POWDER

EBERHARD MANUFACTURING CO.
DIVISION OF
THE EASTERN COMPANY
CLEVELAND, OHIO 44149-9712

UNLESS OTHERWISE SPECIFIED TOLERANCES ARE AS FOLLOWS:	DATE 5-27-08
ANGLES: ±2°	DR/ BY FLP
2 PLACE DEC.: ±.03	SCALE FULL
3 PLACE DEC.: ±.015	CHK. BY
ALL HOLES: ±.005	

NAME BOLT-ON KEEPER	
MATERIAL 32510 MALLEABLE IRON	PART NUMBER 6-1969-1