

CONFIDENTIAL NOTICE: This drawing and the designs, specifications and engineering information disclosed hereon are the property of Eberhard Manufacturing Company and are not to be disseminated or reproduced without express written consent. The drawing is loaned in confidence and then only for consideration of the matter disclosed hereon. In accepting loan of this drawing, recipient agrees to keep it and the matter disclosed hereon in confidence and not to use nor permit their use in any way detrimental to Eberhard Manufacturing Company, Division of the Eastern Company, 21944 Drake Road, Cleveland, Ohio 44149-9712 © 2013 EBERHARD MFG. CO.

REVISION HISTORY			
REV	DESCRIPTION	EN	DATE
	REVISED, REDRAWN AND CONVERTED TO 3D	5587	1-18-13

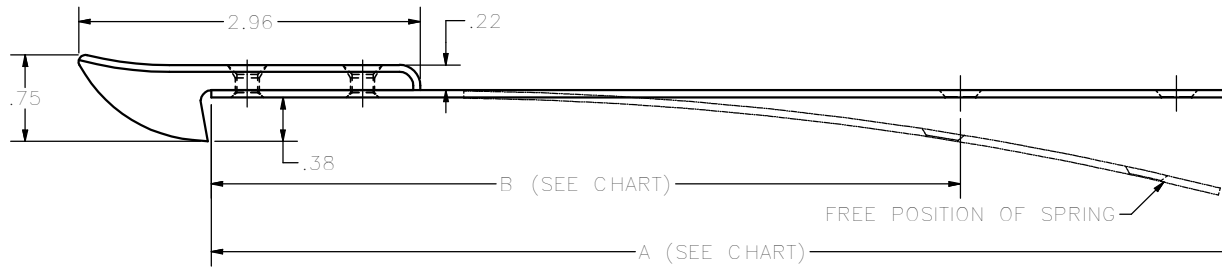
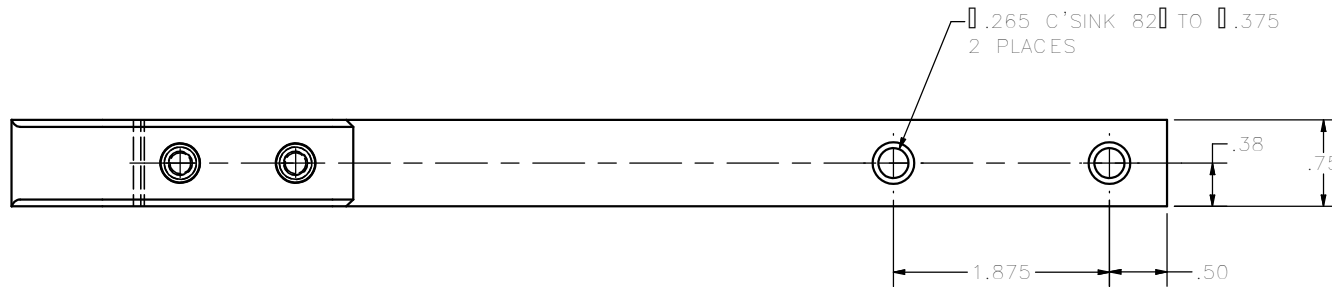

P/N	"A" DIM.	"B" DIM.
5697-C	8.875	6.500
5697-D	9.312	6.937

NOTE; FINISHES:  
 A. PLAIN, FC (01)  
 B. E-COAT, FC (23)

SUPERSEDES DRAWING 5697-C/D CHART DATED 5-17-96

CUSTOMER PRINT  
 SHEET 1 OF 2

**EBERHARD MANUFACTURING CO.**  
 DIVISION OF  
 THE EASTERN COMPANY  
 CLEVELAND, OHIO 44149-9712

THIS DOCUMENT IS IN ACCORDANCE WITH ASME Y14.15-2009		PART 1/18/2013
UNLESS OTHERWISE SPECIFIED TOLERANCES ARE AS FOLLOWS:		DRY BY
ANGLES:	$\varnothing .0$ $\varnothing .0$	FLP
2 PLACE DEC.:	$\varnothing .03$ $\varnothing .76$	SCALE FULL
3 PLACE DEC.:	$\varnothing .015$ $\varnothing .38$	MATERIAL
ALL HOLES:	$\varnothing .015$ $\varnothing .71$	CHK. BY

NAME END GATE FASTENER		
MATERIAL	PART NUMBER	CHART
-----	5697-C	