

CONFIDENTIAL NOTICE: This drawing and the designs, specifications and engineering information disclosed herein are the property of Eberhard Manufacturing Company and are not to be disseminated or reproduced without express written consent. The drawing is loaned in confidence and then only for consideration of the matter disclosed herein. In accepting loan of this drawing, recipient agrees to keep it and the matter disclosed herein in confidence and not to use nor permit their use in any way detrimental to Eberhard Manufacturing Company, Division of the Eastern Company, 21944 Drake Road, Cleveland, Ohio 44149-9712 © 2011 EBERHARD MFG. CO.

REVISION HISTORY			
REV	DESCRIPTION	EN	DATE
	RELEASED WAS M10378	5522	9/23/2011
1	ADD VOLVO STD 121-0001, Y600-1 to NOTE 1	5525	10/14/2011
2	ADD KEY CYL DIMS, ADD NOTE 2	5527	10/28/2011

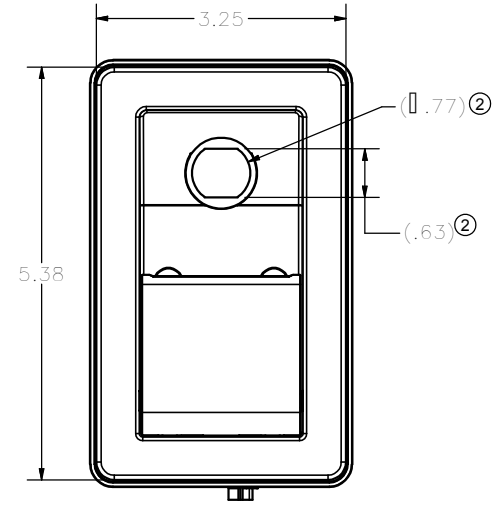

RIGHT HAND;
WHITE CLIP THIS ORIENTATION.
RECOMMENDED .156 ROD.

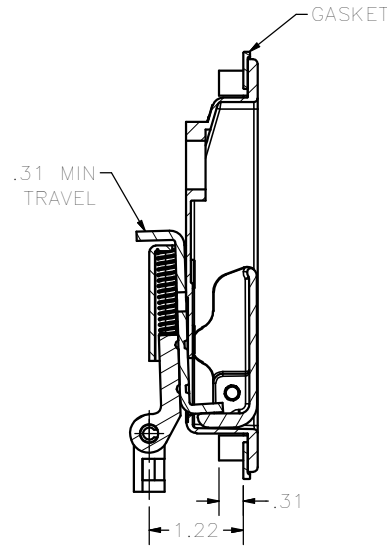
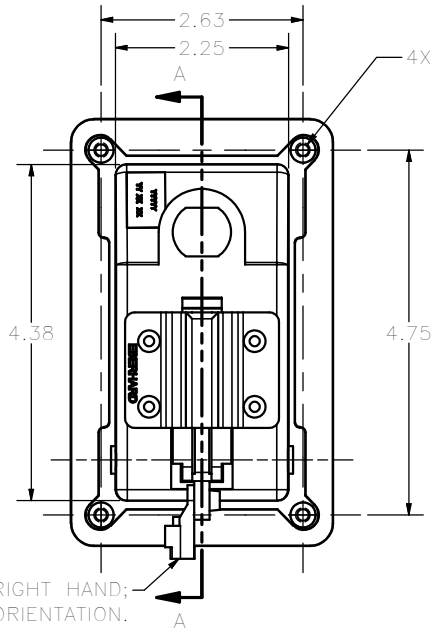
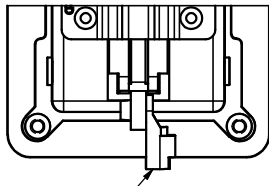

LEFT HAND;
BLACK CLIP THIS ORIENTATION.
RECOMMENDED .156 ROD.

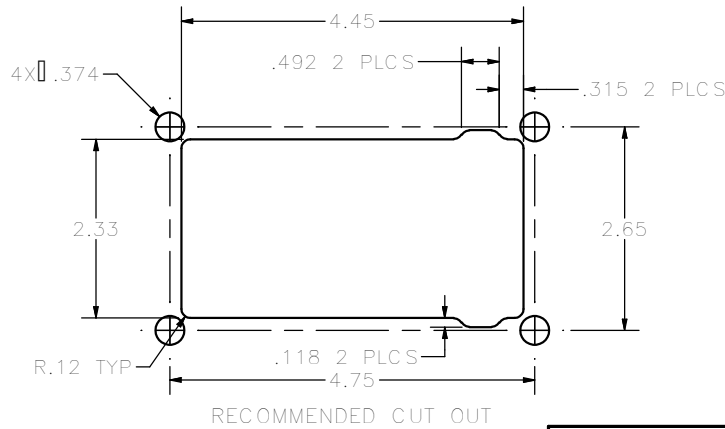

CUSTOMER PRINT
SHEET 1 OF 2
RIGHT HAND SHOWN
LEFT HAND OPPOSITE

NOTES:

- 1) FINISH: (23) E-COAT PER VOLVO STD 121-0001, Y600-2. ①
- 2) SHIPPED IN SECURED POLY BAG ②

UNLESS OTHERWISE SPECIFIED TOLERANCES ARE AS FOLLOWS:	DATE: 9/23/2011	NAME: RECESSED PADDLE HANDLE	
	DR.BY: RBernot	DOOR LOCK w/o KEY CYLINDER	
ANGLES: .0	SCALE:	MATERIAL:	PART NUMBER:
2 PLACE DEC.: .03	CHK.BY:	-----	4850-LCRL
3 PLACE DEC.: .015			
ALL HOLES: .005			