

CONFIDENTIAL NOTICE: This drawing and the designs, specifications and engineering information disclosed hereon are the property of Eberhard Manufacturing Company and are not to be disseminated or reproduced without express written consent. The drawing is loaned in confidence and then only for consideration of the matter disclosed hereon. In accepting loan of this drawing, recipient agrees to keep it and the matter disclosed hereon in confidence and not to use nor permit their use in any way detrimental to Eberhard Manufacturing Company, Division of the Eastern Company, 21844 Drake Road, Cleveland, Ohio 44149-8712. © 2012 EBERHARD MFG. CO.

REVISION HISTORY					
REV	DESCRIPTION	EN	DATE	REV.BY	APVD.BY
1	REVISED, REDRAWN AND CONVERTED TO 3D	5553	5-11-12		
1	Obsolete finish (PW) Add finish (13), Updated font/ notes	5840	2/14/20	DJK	MR

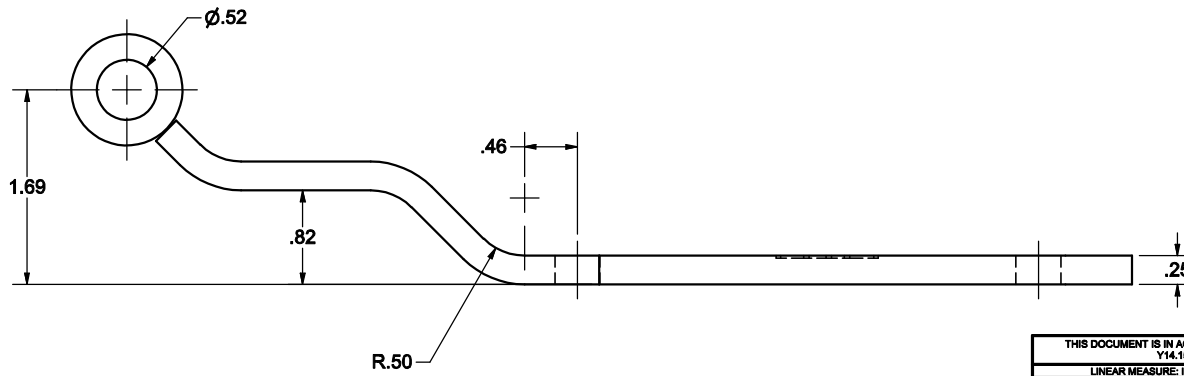
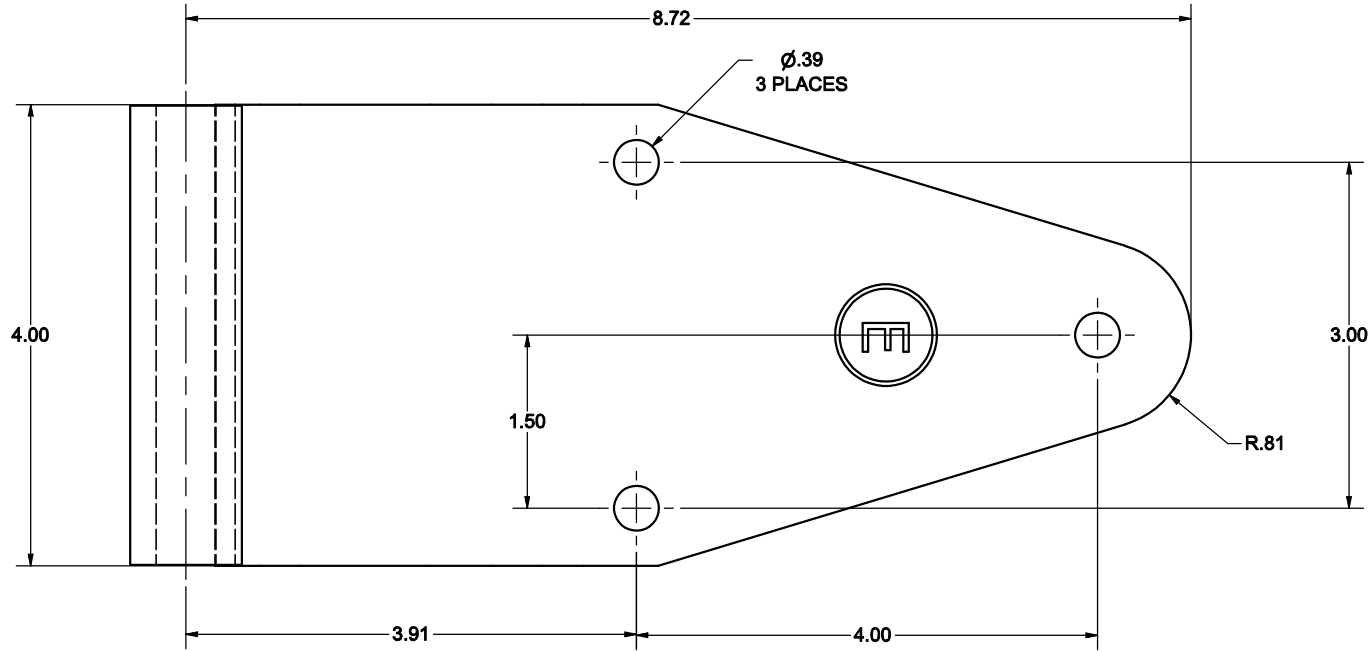

① NOTE: Eberhard Finish: (13) Hot-Dip Galvanize

SUPERSEDES DRAWING 31-5897-50 SH1 DATED 2-12-98.

THIS DOCUMENT IS IN ACCORDANCE WITH ASME Y14.15-2009	
LINEAR MEASURE: INCH	DATE: 5/11/2012
UNLESS OTHERWISE SPECIFIED TOLERANCES ARE AS FOLLOWS:	DR.BY: FLP
ANGLES: ± 2° ± 2°	SCALE: FULL
2 PLACE DEC.: ± .03 ± .76	CHKBY:
3 PLACE DEC.: ± .015 ± .38	
ALL HOLES: ± .005 ± .13	

CUSTOMER PRINT
SHEET 1 OF 2

EBERHARD MANUFACTURING CO.
DIVISION OF
THE EASTERN COMPANY
CLEVELAND, OHIO 44149-8712

NAME
HINGE STRAP SUB-ASSEMBLY

MATERIAL: * PART NUMBER: 31-5897-50