

NO	CHANGE	ENG.NO.	DATE
1	RELEASED	DI 4823	12-19-97

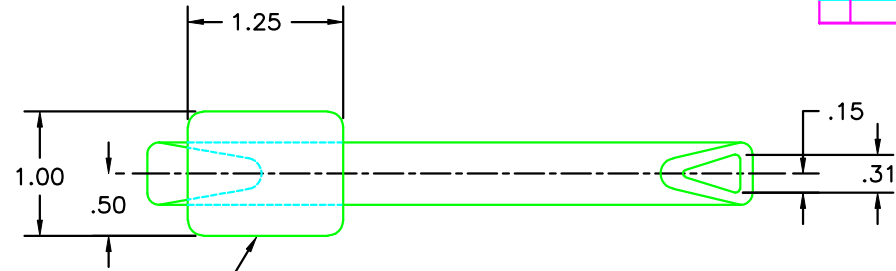

E & PART NUMBER
TO APPEAR ON THIS
SURFACE.

"STAINLESS STEEL" TO
APPEAR ON THIS
SURFACE.

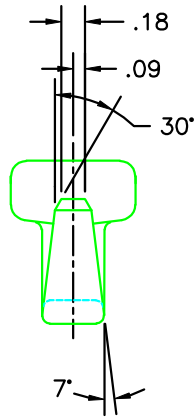
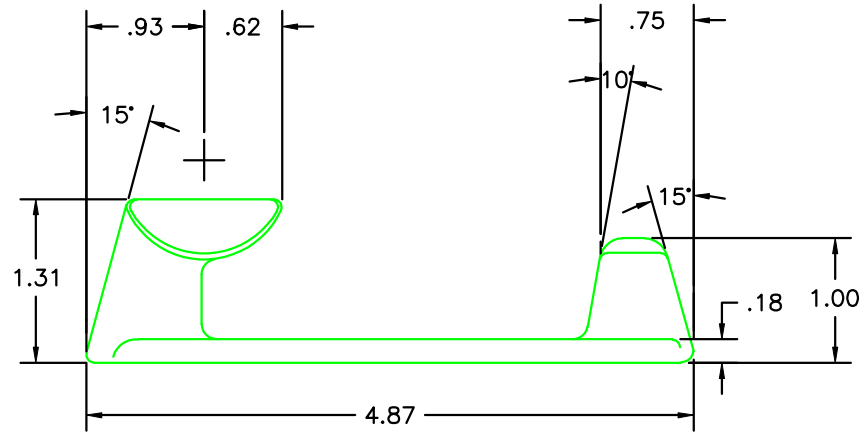
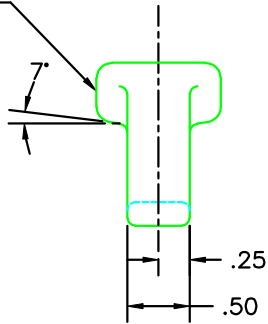

CUSTOMER PRINT
SHEET 1 OF 2

EBERHARD MANUFACTURING CO.
DIVISION OF
THE EASTERN COMPANY
CLEVELAND, OHIO 44136-6697

NOTE:
PARTS TO HAVE PASSIVATED (22) FINISH.

UNLESS OTHERWISE SPECIFIED TOLERANCES ARE AS FOLLOWS:	DATE	12-10-97
	DR. BY	CMB
	SCALE	FULL
	CHK. BY	

NAME		STAINLESS STEEL KEEPER
MATERIAL	INVESTMENT CAST #304	PART NUMBER
	STAINLESS STEEL	1974-SSC1