

CONFIDENTIAL NOTICE: This drawing and the designs, specifications and engineering information disclosed herein are the property of Eberhard Manufacturing Company and are not to be disseminated or reproduced without express written consent. The drawing is loaned in confidence and then only for consideration of the matter disclosed herein. In accepting loan of this drawing, recipient agrees to keep it and the matter disclosed herein in confidence and not to use nor permit their use in any way detrimental to Eberhard Manufacturing Company, Division of the Eastern Company, 21944 Drake Road, Cleveland, Ohio 44149-9712 © 2016 EBERHARD MFG. CO.

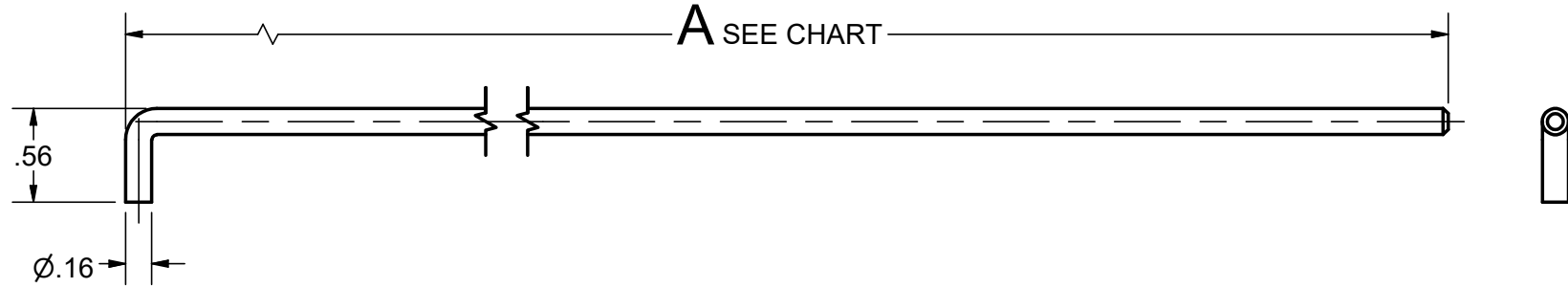

P/N	A
16682	36"
1-16682	48"
2-16682	23.68"
3-16682	52"

NOTE: FINISH: ELECTROPLATED ZINC, FC (25).

CUSTOMER PRINT
SHEET 1 OF 2

SUPERSEDES DRAWING 16682 CHART SHEET 1 OF 2 DATED 2-26-02.

<table border="1"> <thead> <tr> <th colspan="2">LINEAR MEASURE: INCH</th> <th>DATE</th> </tr> </thead> <tbody> <tr> <td colspan="2">UNLESS OTHERWISE SPECIFIED TOLERANCES ARE AS FOLLOWS:</td> <td>4/22/2016</td> </tr> <tr> <td></td> <td>IN</td> <td>MM</td> </tr> <tr> <td>ANGLES:</td> <td>± 2'</td> <td>± 2'</td> </tr> <tr> <td>2 PLACE DEC.:</td> <td>± .03</td> <td>± .76</td> </tr> <tr> <td>3 PLACE DEC.:</td> <td>± .015</td> <td>± .38</td> </tr> <tr> <td>ALL HOLES:</td> <td>± .005</td> <td>± .13</td> </tr> </tbody> </table>						LINEAR MEASURE: INCH		DATE	UNLESS OTHERWISE SPECIFIED TOLERANCES ARE AS FOLLOWS:		4/22/2016		IN	MM	ANGLES:	± 2'	± 2'	2 PLACE DEC.:	± .03	± .76	3 PLACE DEC.:	± .015	± .38	ALL HOLES:	± .005	± .13	EBERHARD MANUFACTURING CO. DIVISION OF THE EASTERN COMPANY CLEVELAND, OHIO 44149-9712		NAME		.156 DIAMETER ROD WITH 90 DEGREE BEND
						LINEAR MEASURE: INCH		DATE																							
UNLESS OTHERWISE SPECIFIED TOLERANCES ARE AS FOLLOWS:		4/22/2016																													
	IN	MM																													
ANGLES:	± 2'	± 2'																													
2 PLACE DEC.:	± .03	± .76																													
3 PLACE DEC.:	± .015	± .38																													
ALL HOLES:	± .005	± .13																													
MATERIAL		PART NUMBER																													
REV	DESCRIPTION	EN	DATE	REV BY	APVD BY	THIS DOCUMENT IS IN ACCORDANCE WITH ASME Y14.5-2009		16682																							
	CONVERTED TO 3D	5749	4-22-16	FLP	MR																										

C:\TEMP\03ab99ae4-013a-4bb0-bc14-7b92cdfa139\FASTENER\RODS\CONNECTING
OFFSET .156 DIA\16682 SH1.idw