

11979511

CONFIDENTIAL NOTICE: This drawing and the design, specifications and engineering information disclosed herein are the property of Berberhard Manufacturing Company and are not to be disseminated or reproduced without express written consent. The drawing is issued in confidence and then only for construction of the matter disclosed herein. In assembly form of this drawing, recipient agrees to keep it and the matter disclosed herein in confidence and not to use our patent, their use in any way disclosed by Berberhard Manufacturing Company, Division of The Eastern Company, 2594 Green Road, Cleveland, Ohio 44136-8897 © 1994 BERBERHARD MFG. CO.

NO	CHANGE	ENG. NO.	DATE
	RELEASED	DR 604	6-7-98

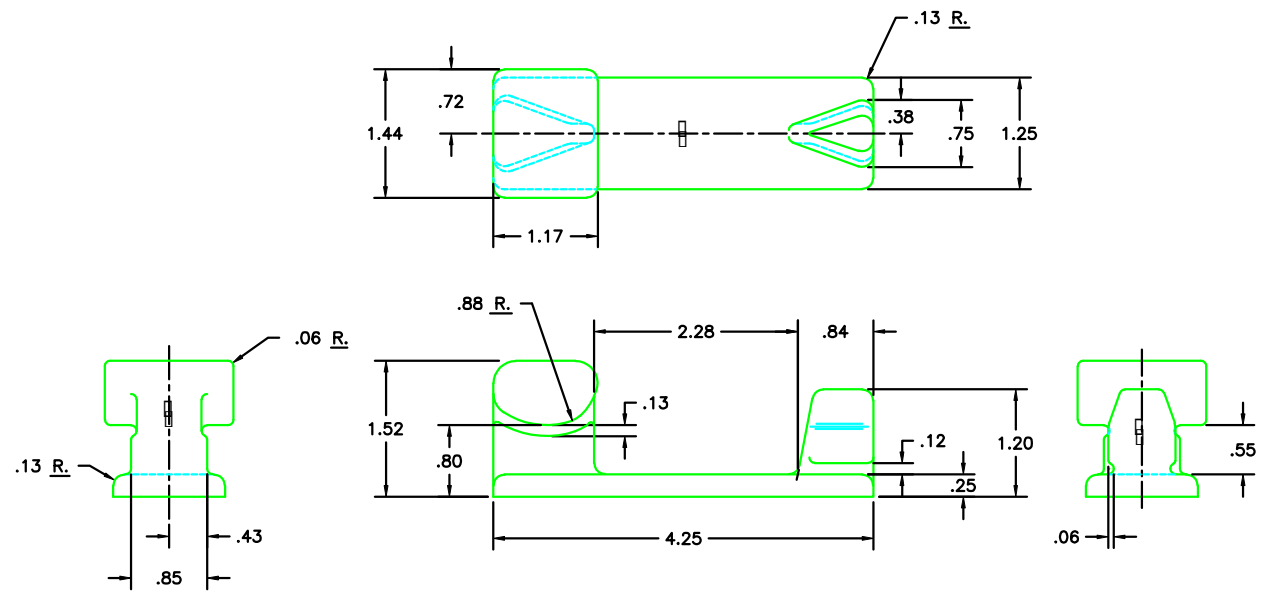

CUSTOMER PRINT
SHEET 1 OF 2

BERBERHARD MANUFACTURING CO.
DIVISION OF
THE EASTERN COMPANY
CLEVELAND, OHIO 44136-8897

UNLESS OTHERWISE SPECIFIED
TOLERANCES ARE AS FOLLOWS:

ANGLES:	±2
2 PLACE DEC.:	±.03
3 PLACE DEC.:	±.016
ALL HOLES:	±.008

DATE
7-13-98
DWG
PLP
SCALE
FULL
CHK'D
GRW

NAME	KEEPER, INVESTMENT CAST
MATERIAL	304 STAINLESS STEEL
PART NUMBER	1-1979-SSC1