

# PARTS LIST

DWG #:	DESCRIPTION	QTY
00047	RI ROTARY LATCH, BOTTOM FRAME	1
00048	RI ROTARY LATCH, TOP FRAME	1
00051	RI ROTARY LATCH, STRIKE	1
00052	RI ROTARY LATCH, JOY STICK	1
00053	RI ROTARY LATCH, PIVOT PLATE	1
00054	SPRING, COMPRESSION, 0.219" x 0.875"	1
00056	SPRING, RI PIVOT PLATE, 0.640" x 0.200"	1
00057	SPRING, STRIKE LATCH, LH, 0.079" X 0.180", 0.063" WD	1
00058	RIVET, RI JOY STICK SPRING	1
00794	AXLE, ROTARY, 20LB	2
00795	SPACER, AXLE, R5 ROTARY LATCH	2

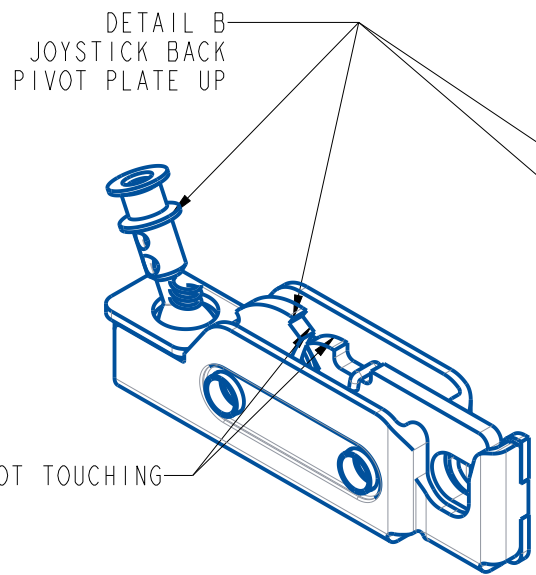

REQUIRED PUSH TEST OF 8-12 LBS AT CENTER OF HOLE WITH JOY STICK HELD IN ENGAGED POSITION TO HOLD PIVOT PLATE AWAY FROM STRIKE WHILE ROTATING

REQUIRED PULL TEST AT CENTER OF CABLE CLAMP OF 2.25 LBS - 3 LBS MOVEMENT 0 - 0.250" - WITH STRIKE IN THE OPEN POSITION

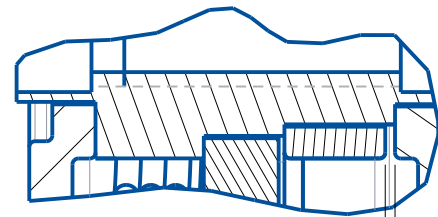
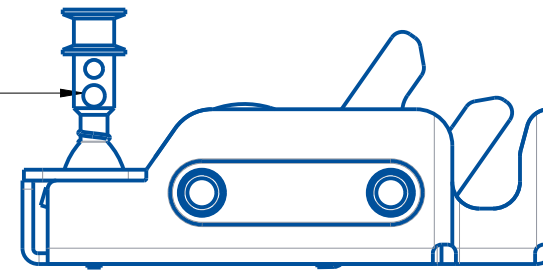
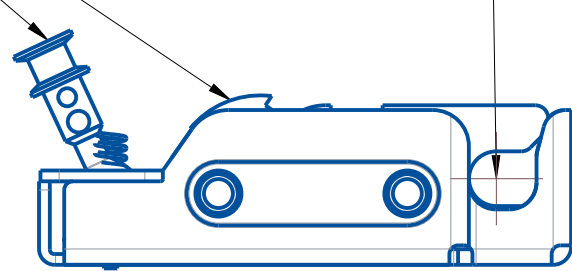

DETAIL A  
SCALE 3.000

.022  
.017 BETWEEN PARTS 00795 AND 00047

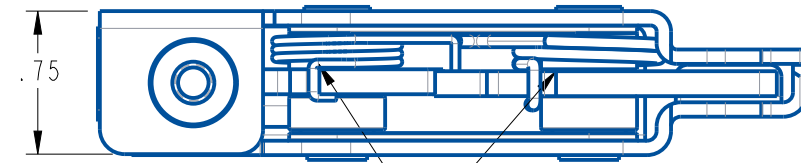

APPLY OIL TO SPRINGS AND AXLES HERE

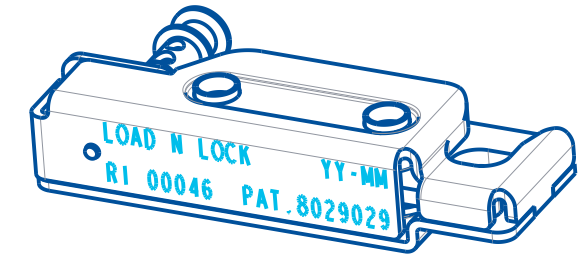

AXLE AND FRAMES SHOULD BE MATED TO EACH OTHER AFTER RIVETING

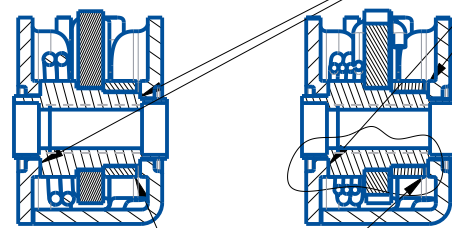

SECTION A-A

SECTION B-B

SEE DETAIL A

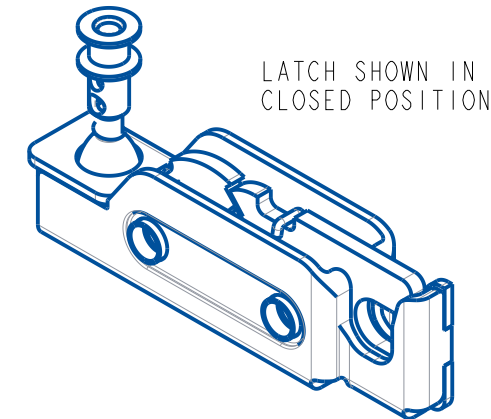
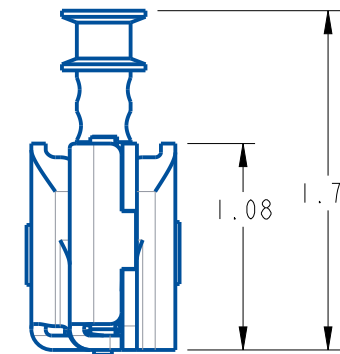
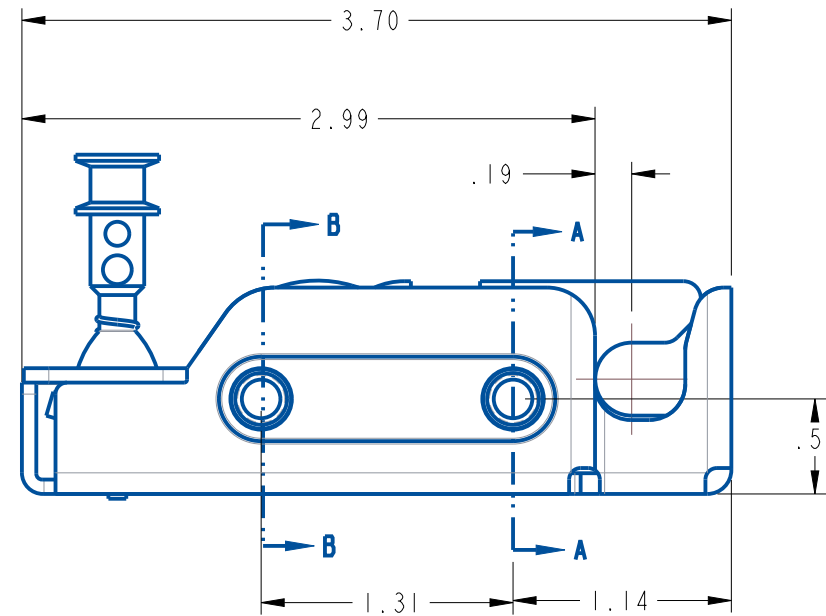

LATCH SHOWN IN CLOSED POSITION

BUILD TOLERANCES X.X ±0.030 X.XX ±0.015 X.XXX ±0.005 X.XXXX ±0.003 ANGLES ±1° INSP. PT.	FINISH:	BLACK E-COAT AFTER ASSEMBLY	MAT'L:	ASSY
	DESCRIPTION:	RI ROTARY LATCH, MULTI-DIR, 10 lbs		
	REV. LEVEL:	A	REV. DATE:	10-DEC-20
	ECN #:	433	SHEET	1 OF 1
	UNITS:	INCH	SCALE:	SEE NOTES
	DATE:	10-DEC-20	DWG SIZE:	B

P/N: 00046-1



[www.loadnlocksystems.com](http://www.loadnlocksystems.com)